



7400 West 129th Street, Suite 100 | Overland Park, KS 66213 | [www.69express.org](http://www.69express.org) | [info@69express.org](mailto:info@69express.org)

IMMEDIATE RELEASE  
May 29, 2024

For more information:  
Delaney Tholen  
785-817-9365  
[delaney.tholen@ks.gov](mailto:delaney.tholen@ks.gov)

## **Southbound U.S. 69 segment will be fully closed overnight May 29 and May 30**

All southbound U.S. 69 lanes, from 119<sup>th</sup> Street to Blue Valley Parkway, and the 119<sup>th</sup> Street to southbound U.S. 69 entrance ramp in Overland Park will be **fully closed** to traffic overnight from:

- 7 p.m. Wednesday, May 29 to 6 a.m. Thursday, May 30
- 7 p.m. Thursday, May 30 to 6 a.m. Friday, May 31

Detours will be marked.

These temporary closures are necessary for bridge work on the new Blue Valley Parkway to southbound U.S. 69 flyover entrance ramp and are part of the KDOT U.S. 69 Expansion Project (69Express). All scheduled project work is weather permitting and subject to change.

### **During the closure, detours will be marked as follows:**

- Southbound U.S. 69: traffic will be directed to exit at 119<sup>th</sup> Street and turn left onto 119<sup>th</sup> Street, then travel east to Blue Valley Parkway and turn right to travel south and use the Blue Valley Parkway to southbound U.S. 69 entrance ramp.
- 119<sup>th</sup> Street to enter southbound U.S. 69: traffic will be directed to turn south onto Switzer Road, then turn left onto 135<sup>th</sup> Street to use the 135<sup>th</sup> Street to southbound U.S. 69 entrance ramp.

The 69Express project includes reconstruction of U.S. 69, widening the highway with added express lanes – one in each direction between 151<sup>st</sup> and 103<sup>rd</sup> Streets – and interchange improvements at U.S. 69/167<sup>th</sup> Street in Overland Park.

# 69 EXPRESS

7400 West 129th Street, Suite 100 | Overland Park, KS 66213 | [www.69express.org](http://www.69express.org) | [info@69express.org](mailto:info@69express.org)

*Map below shows closure location marked in red and detour route marked in blue.*

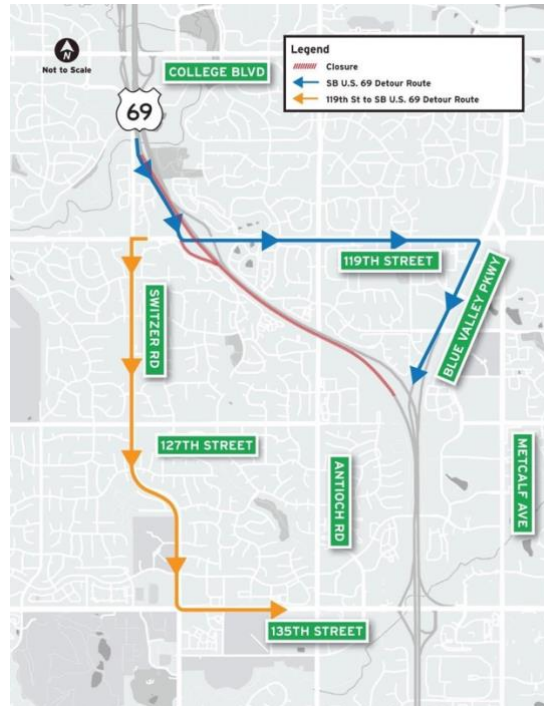

All current U.S. 69 corridor construction and closure information is available on the 69Express project website, [www.69express.org](http://www.69express.org). For additional information, members of the public can get regular construction updates on the project on [Facebook](#) and [X](#) (formerly Twitter) pages and by [subscribing to the project newsletter](#) and [signing up to receive text message alerts](#).

###

This information can be made available in alternative accessible formats upon request. For information about obtaining an alternative format, contact the KDOT Division of Communications, 700 SW Harrison St., 2<sup>nd</sup> Fl. West, Topeka, KS 66603-3745 or phone 785-296-3585 (Voice) / 7-1-1 (Hearing Impaired).

**Click below to connect to KDOT's Social Networks:**

